

LEGEND:

- = EXISTING WALL
- = NEW WALL

NOTES:

- DIMENSIONS ARE FOR GENERAL REFERENCE ONLY. CONTRACTOR TO VERIFY IN FIELD.
- ALL WORK TO COMPLY WITH CURRENT INTERNATIONAL CODES.
- ELECTRICAL WORK TO BE IN ACCORDANCE WITH NFPA 70-17 NATIONAL ELECTRIC CODE.
- ALL GAS PIPING TO BE IN ACCORDANCE WITH 2018 INTERNATIONAL FUEL GAS CODE.
- ALL PLUMBING WORK TO BE IN ACCORDANCE WITH THE 2018 INTERNATIONAL PLUMBING CODE.
- HEATING EQUIPMENT TO BE INSTALLED PER 2018 INTERNATIONAL MECHANICAL CODE.

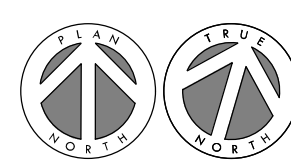
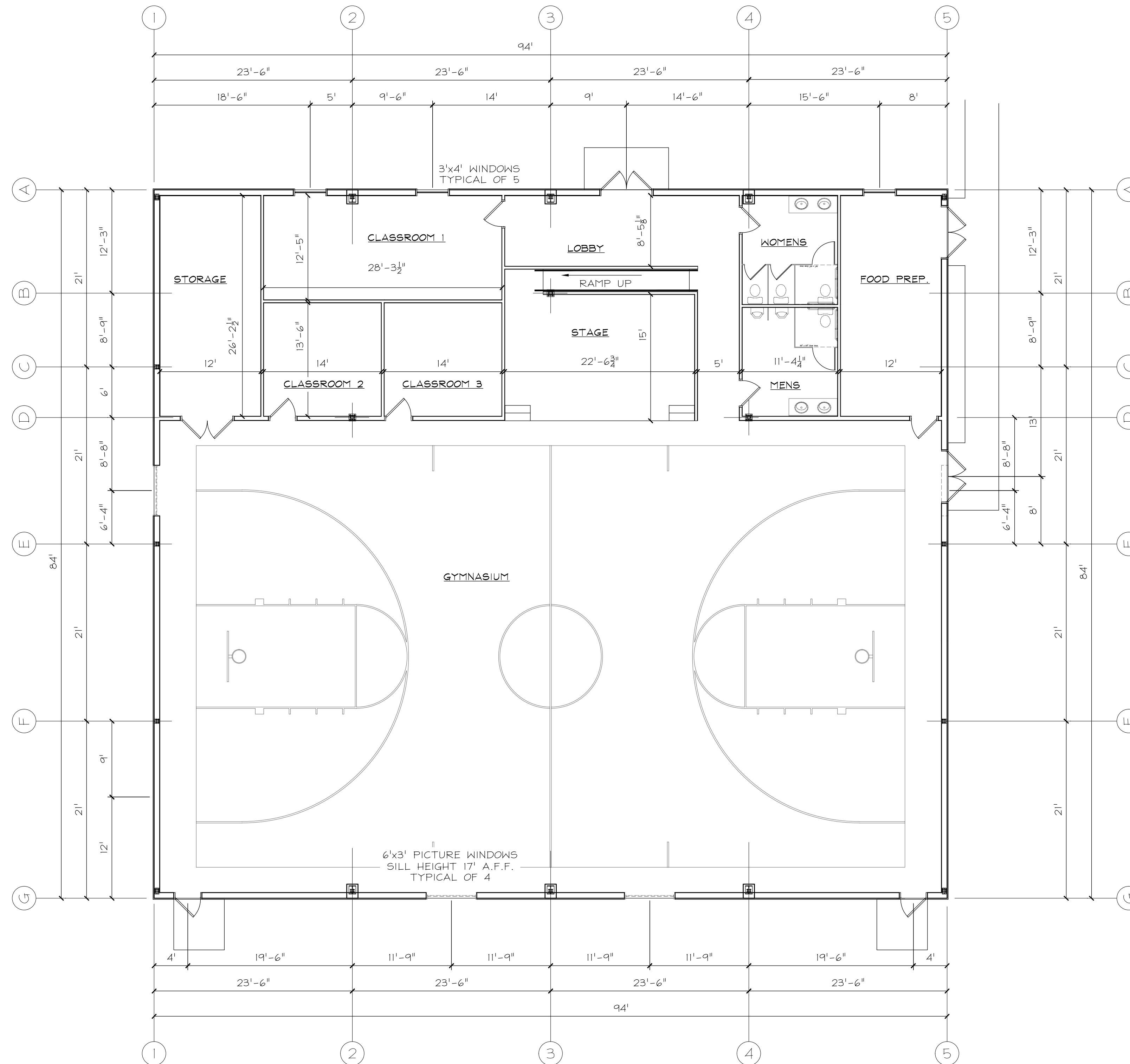

PRELIMINARY FLOOR PLAN
SCALE: 1/8" = 1'-0"

10/16/2025 10:20 AM W:\2023 PROJECTS\23-042 HILLTOP BAPTIST CHURCH\23-042-BS HILLTOP BAPTIST CHURCH.DWG

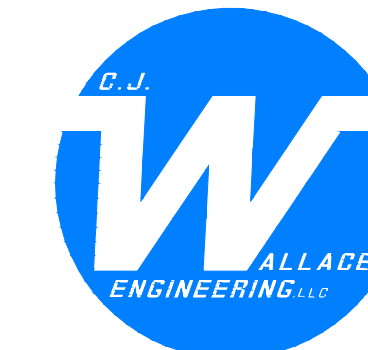

31 BOYLSTON STREET
BRADFORD, PA 16701
P 814.362.2000
cwallace@cjwallc.com

PROFESSIONAL STAMP

PRELIMINARY
DRAWING
NOT FOR
CONSTRUCTION

PROJECT NAME
MULTI-PURPOSE BUILDING

3658 SR 0646
GIFFORD, PA 16732
CLIENT INFO

HILLTOP BAPTIST CHURCH

3658 SR 0646
GIFFORD, PA 16732

REVISIONS

#	DATE	DESCRIPTION
1	9/12/23	CJW/ PRELIMINARY PLANS
2	9/26/23	CJW/ REVISED PRELIMINARY PLANS
3	10/16/25	CJW/ UPDATED BUILDING LOCATION

PROJECT NO. 23-042

DWG DATE: 10/16/25

DRAWN BY: CJWE

SHEET TITLE
**PRELIMINARY
FLOOR PLAN**

SHEET NUMBER

A-101